

# DISTRIBUTEURS A COMMANDE MECANIQUE SERIE 70 G 1/8

## CARACTERISTIQUES TECHNIQUES

Raccordement	G 1/8
Force d'actionnement à 6 bar:	
• Version à commande directe	50 N
• Version servopilotée	6 N
Pression d'utilisation	
• Version à commande directe	Vide à 10 bar
• Version servopilotée	2,5 à 10 bar
Température d'utilisation	-10°C à +60°C
Diamètre nominal	5 mm
Conductance C	121.43 NI/min · bar
Ratio critique b	0.32 bar/bar
Débit nominal à 6 bar ΔP 0.5 bar	400 NI/min
Débit nominal à 6 bar ΔP 1 bar	550 NI/min

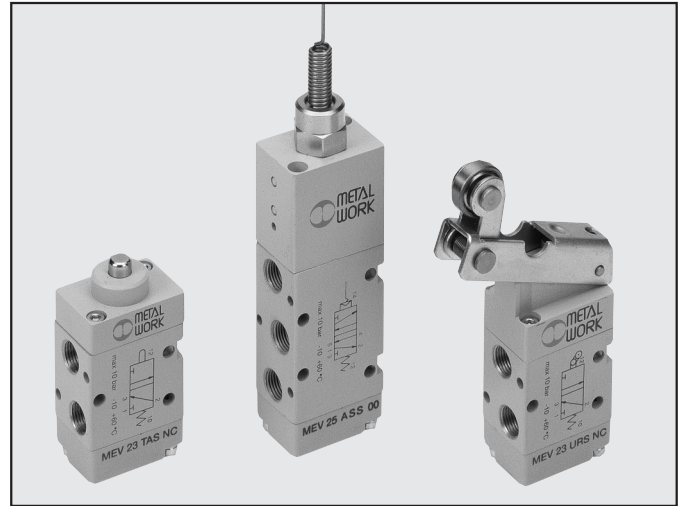

## CLEFS DE CODIFICATION

M	E	V	2	3	T	A	S	N	C	
FAMILLE			RAC.	FONCTION	COMMANDE 14		RETOUR 12	COMPLEMENT DE DESCRIPTION		
MEV	mécanique		2 G 1/8	3 3/2 5 5/2	TA BR UR TS RS AS LL	poussoir levier à galet bidirect. levier à galet unidirect. poussoir servopiloté levier à galet bidirect. servo. antenne servopilotée galet réglable	S A	ressort pneumo- mécanique*	NC OO	norm. fermé 5/2
							*sur demande			

### POUSSOIR 3/2 G 1/8

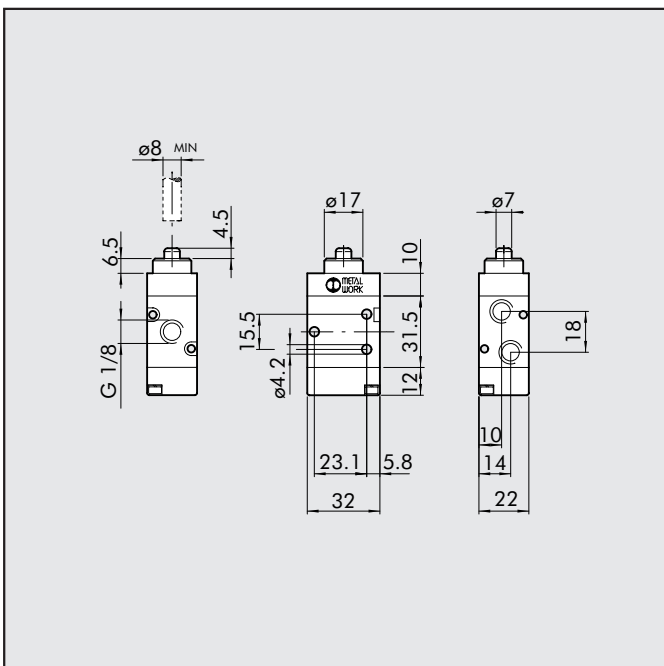

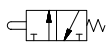
Symbole	Type	Code	Poids [g]
	MEV 23 TAS NC	7001000100	88

### POUSSOIR 5/2 G 1/8

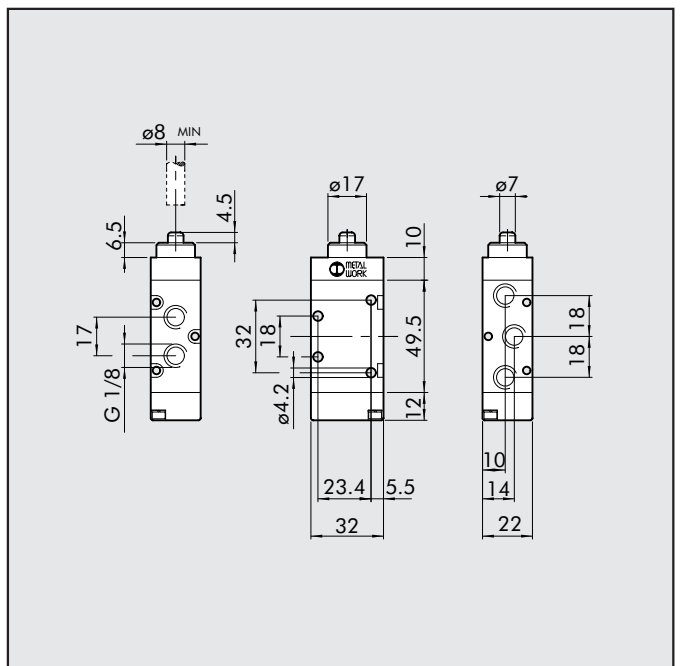

Symbole	Type	Code	Poids [g]
	MEV 25 TAS OO	7001000110	114



### LEVIER A GALET BIDIRECTIONNEL 3/2 G1/8

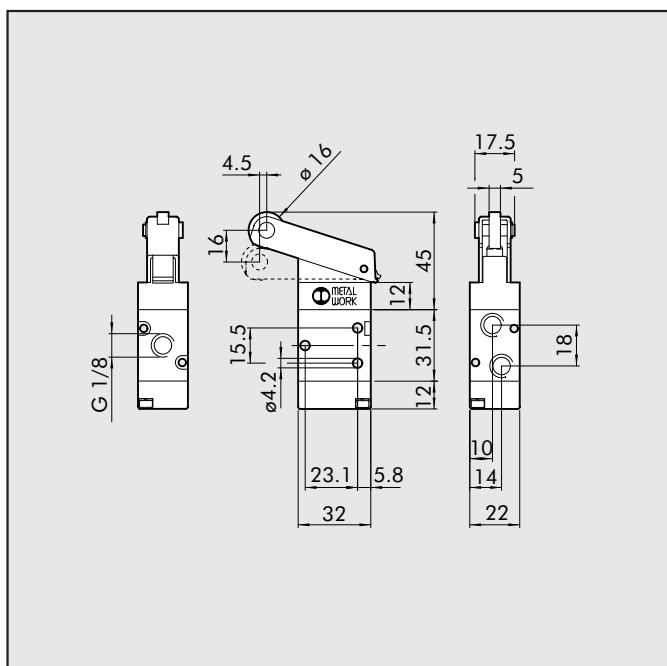

Symbole	Type	Code	Poids [g]
	MEV 23 BRS NC	7001000500	130

### LEVIER A GALET BIDIRECTIONNEL 5/2 G1/8

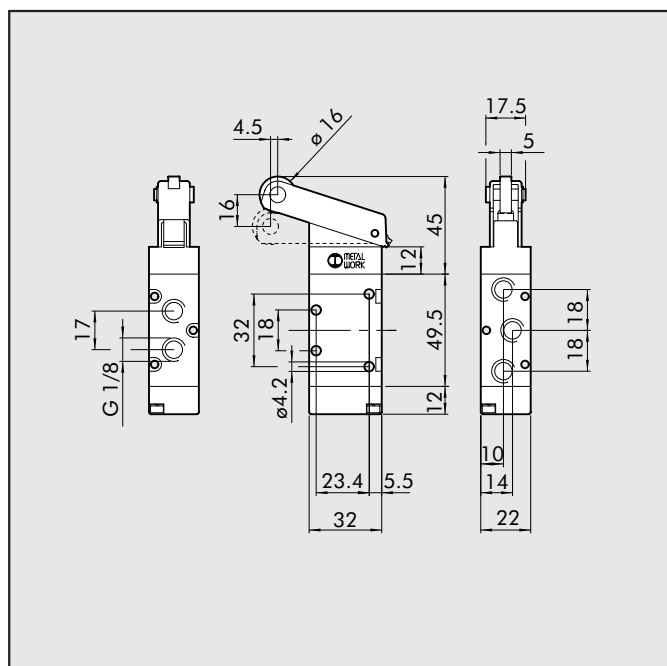

Symbole	Type	Code	Poids [g]
	MEV 25 BRS OO	7001000510	156

### LEVIER A GALET UNIDIRECTIONNEL 3/2 G1/8

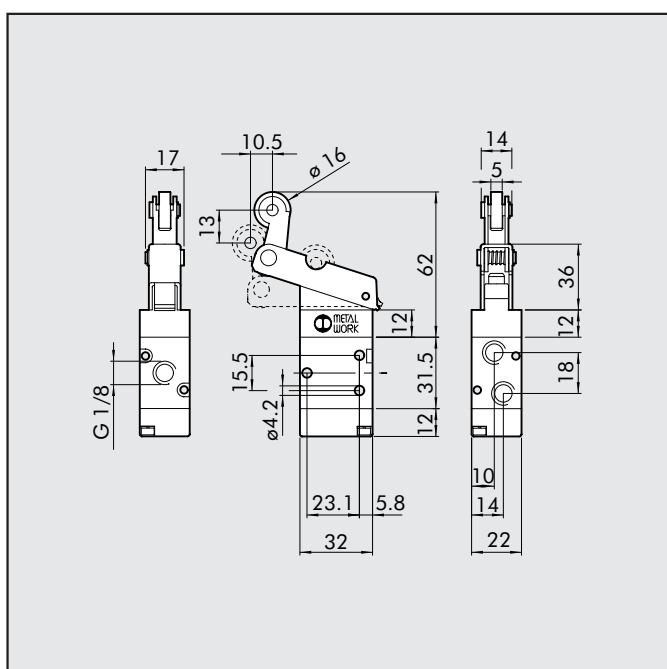

Symbole	Type	Code	Poids [g]
	MEV 23 URS NC	7001000600	136

### LEVIER A GALET UNIDIRECTIONNEL 5/2 G1/8

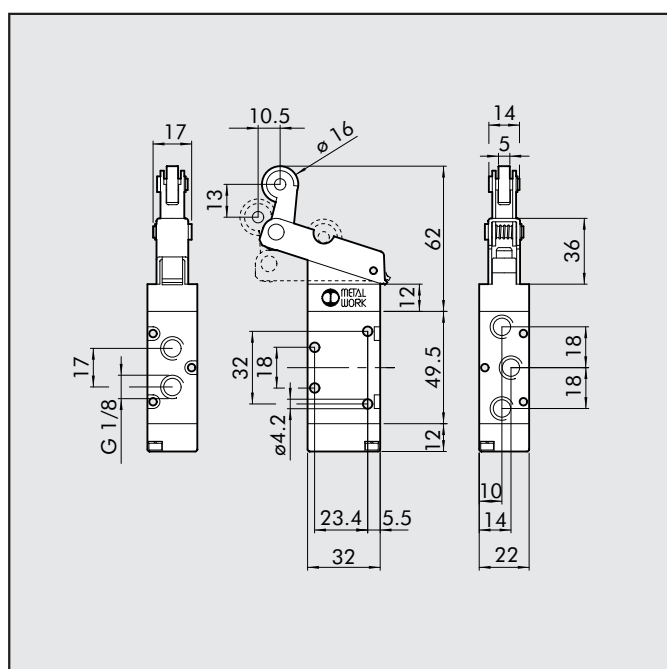

Symbole	Type	Code	Poids [g]
	MEV 25 URS OO	7001000610	162

# DISTRIBUTEURS A COMMANDE MECANIQUE SERIE 70 G 1/8

## POUSSOIR SERVOPILOTE 3/2 NF G1/8

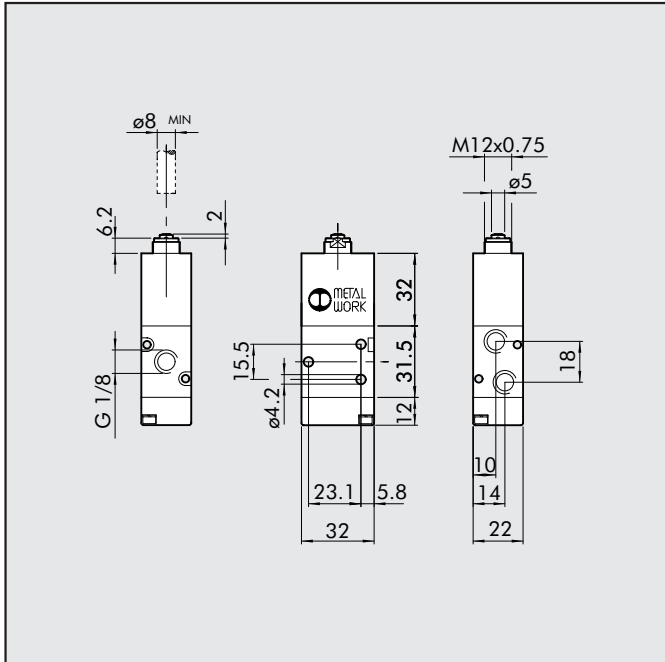

Symbole	Type	Code	Poids [g]
	MEV 23 TSS NC	7001000200	126

## POUSSOIR SERVOPILOTE 5/2 G1/8

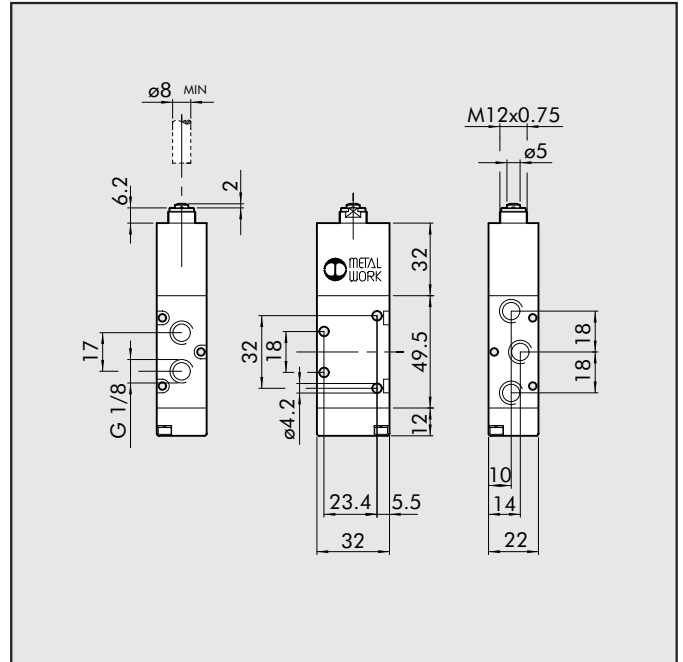

Symbole	Type	Code	Poids [g]
	MEV 25 TSS OO	7001000210	152

## GALET BIDIRECTIONNEL SERVOPILOTE 3/2 NF G1/8

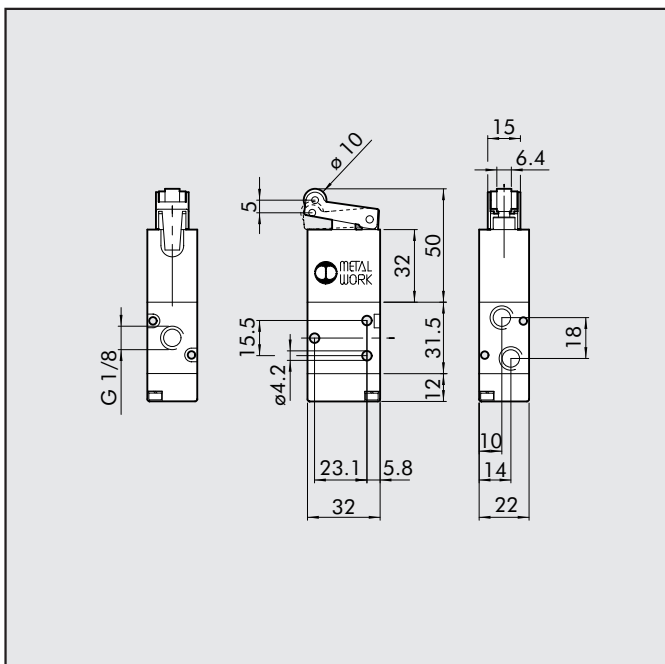

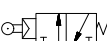
Symbole	Type	Code	Poids [g]
	MEV 23 RSS NC	7001000400	138

## GALET BIDIRECTIONNEL SERVOPILOTE 5/2 G1/8

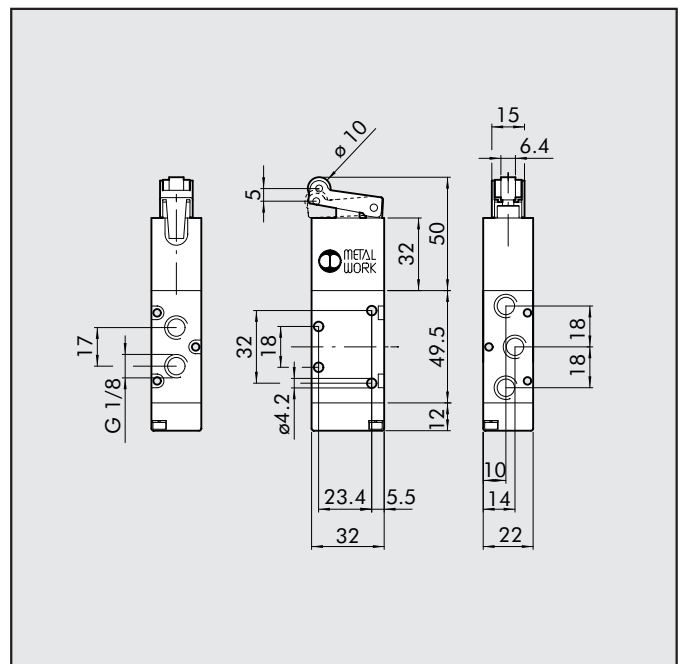

Symbole	Type	Code	Poids [g]
	MEV 25 RSS OO	7001000410	164



### ANTENNE SERVOPILOTE 3/2 NF G 1/8

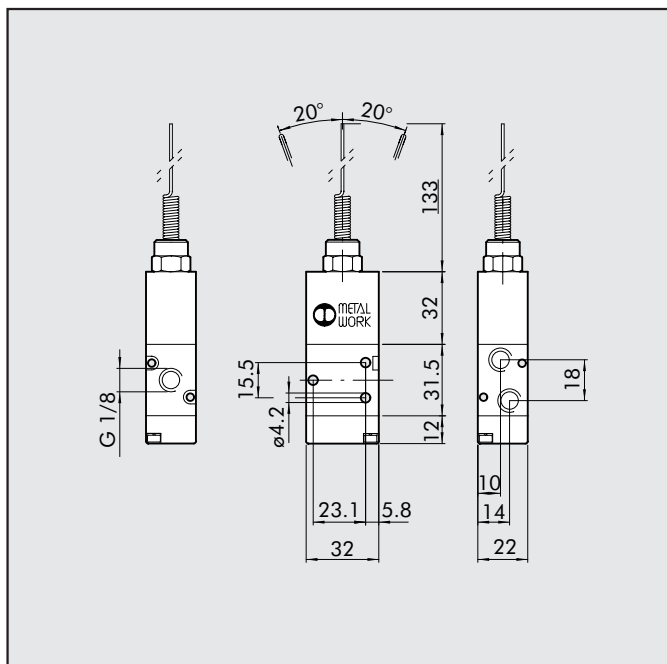

Symbole	Type	Code	Poids [g]
	MEV 23 ASS NC	7001000700	142

### ANTENNE SERVOPILOTE 5/2 G 1/8

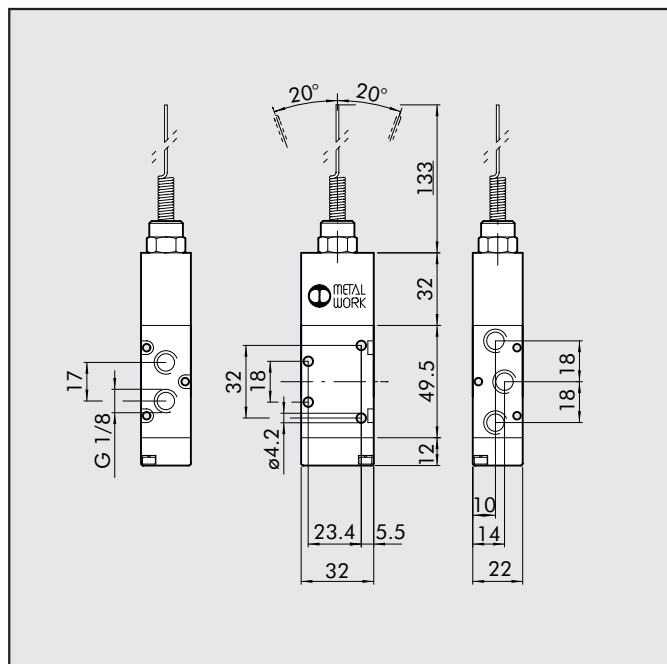

Symbole	Type	Code	Poids [g]
	MEV 25 ASS OO	7001000710	168

### GALET REGLABLE 3/2 G 1/8

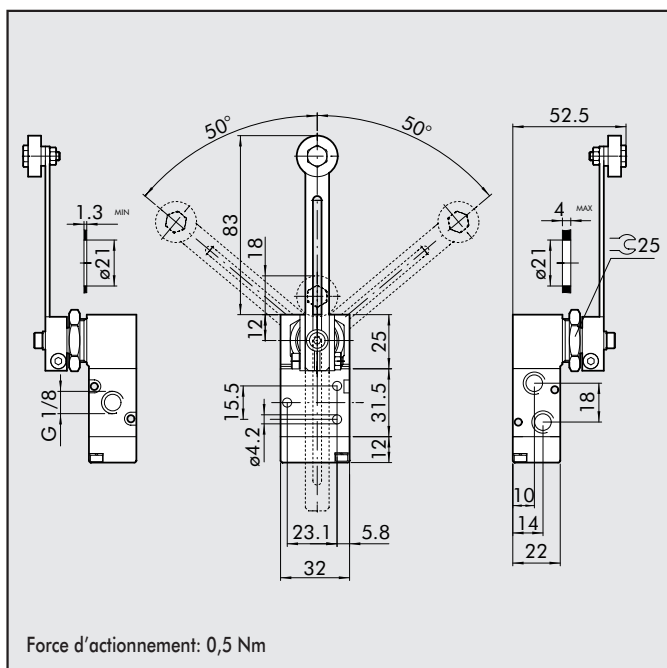

Force d'actionnement: 0,5 Nm

Symbole	Type	Code	Poids [g]
	MEV 23 LLS NC	7001000900	189

### GALET REGLABLE 5/2 G 1/8

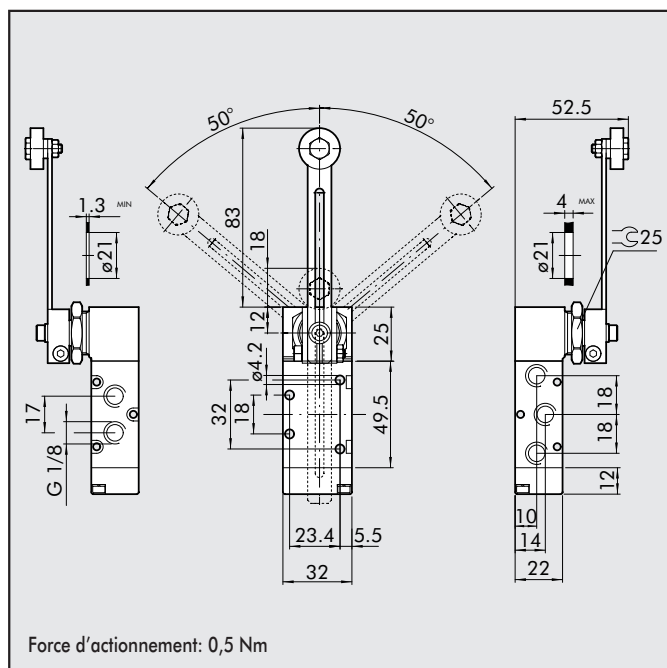

Force d'actionnement: 0,5 Nm

Symbole	Type	Code	Poids [g]
	MEV 25 LLS OO	7001000910	216